

1

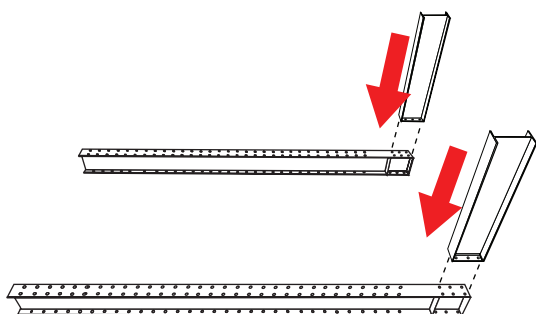

### Attach the Columns to the Bases

- Lay Columns on the floor to attach to the Bases.
- Attach columns to bases using (6) ea. 3/4" Nuts/Bolts.

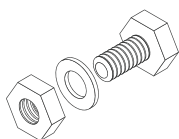
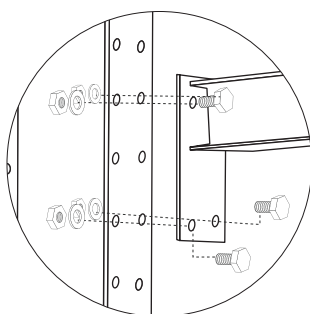
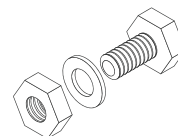
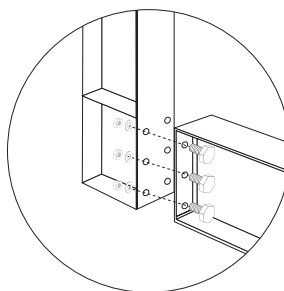

### Attach the Arms to the Columns

- Mark the Arm positions on the Columns with chalk
- Attach Arms to Columns using (4) ea. 3/4" Nuts/Bolts.

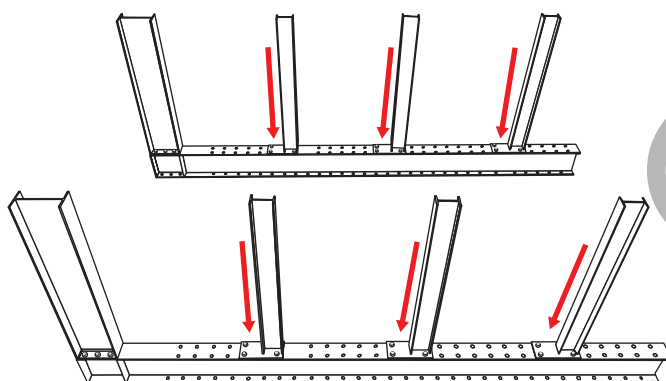

2

3

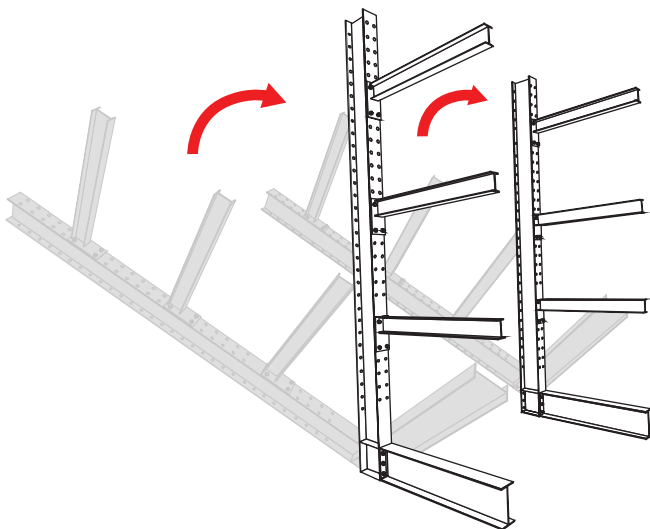

### Stand the Columns/ Bases up

- With enough man power, a forklift or crane stand the connected Columns/Bases up.
- Place the Columns/Bases in their final position.

4

### Assemble a Starter Unit

- Using 3/4" Nuts/Bolts, attach the horizontal Braces to the connection points on the inside of the Columns. DO NOT tighten the Bolts!
- Attach the diagonal Brace (X-Braces) to the same connection points on the inside of the Columns.
- Tighten all Bolts/Nuts securely.

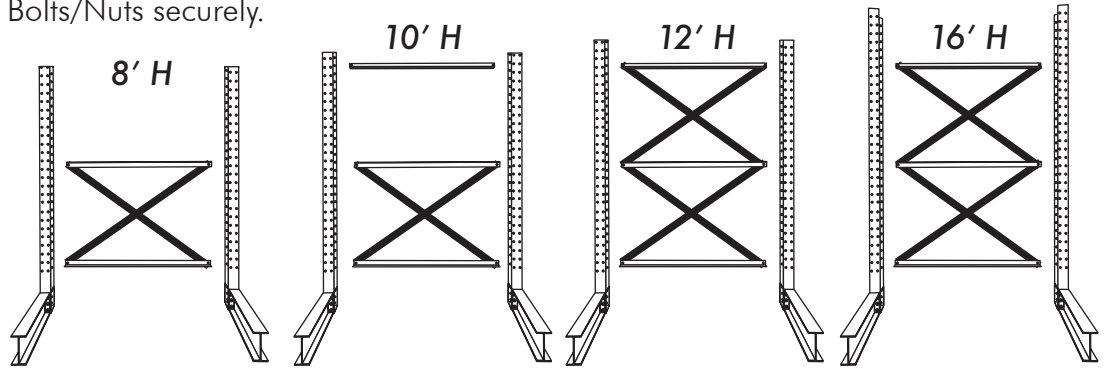

### Optional – Add-on Bay(s)

1. Attach the Base to the Column.
2. Attach the horizontal and diagonal Braces to the last open Column.
3. Stand Column up and attach to open side of the Braces.
4. Tighten all Braces.
5. Repeat for all Bays.

5

## DISCLAIMER

Action Wholesale Products recommends that this product be assembled only by qualified personnel, experienced in this assembly of storage racks, and knowledgeable of all safety regulations and practices. These instructions are intended only for use by qualified individuals using all proper safety equipment.