

1

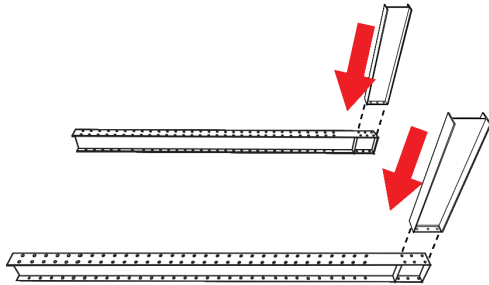

### Attach the Columns to the Bases

- Lay Columns on the floor to attach to the Bases.
- Attach columns to bases using (6) ea. 2" long Nuts/Bolts.

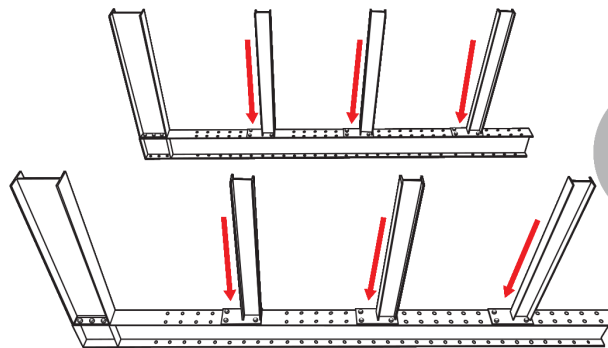
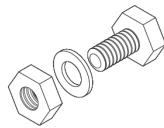
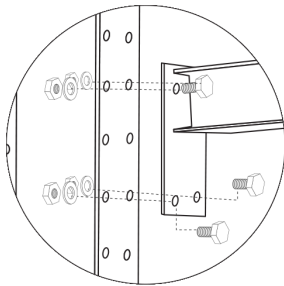
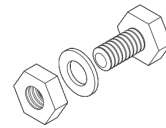
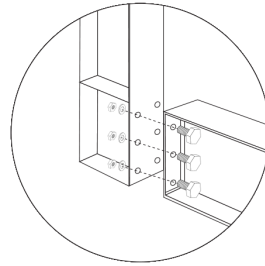

2

### Attach the Arms to the Columns

- Mark the Arm positions on the Columns with chalk
- Attach Arms to Columns using (4) ea. 2" long Nuts/Bolts.

3

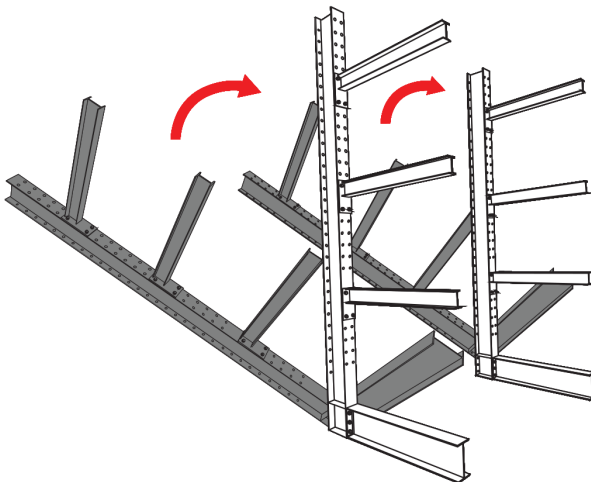

### Stand the Columns/ Bases up

- With enough man power, a forklift or crane stand the connected Columns/Bases up.
- Place the Columns/Bases in their final position.

### Assemble & Install the Brace Set (4' and 6' wide)

- Using 2 ½" nuts/bolts, attach the diagonal braces to the horizontal braces in an "X" pattern.
- Using the 1 ½" nuts/bolts attach the Brace Set to the connection points on the inside of the Columns.
- Tighten all nuts/bolts securely.

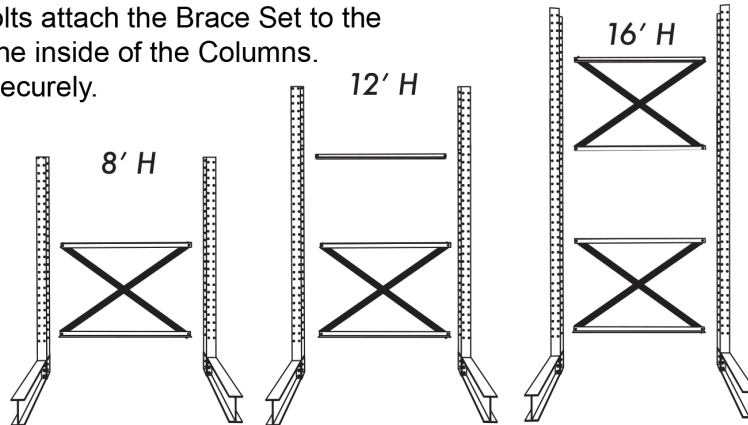

4

### For 8' wide Brace Sets

- Using the 2 ½" nuts/bolts to create TWO "X" wit the diagonal braces in between the horizontal braces as shown in the drawings below.
- Using the 1 ½" nuts/bolts attach the Brace Set to the connection points on the inside of the Columns.
- Tighten all nuts/bolts securely.

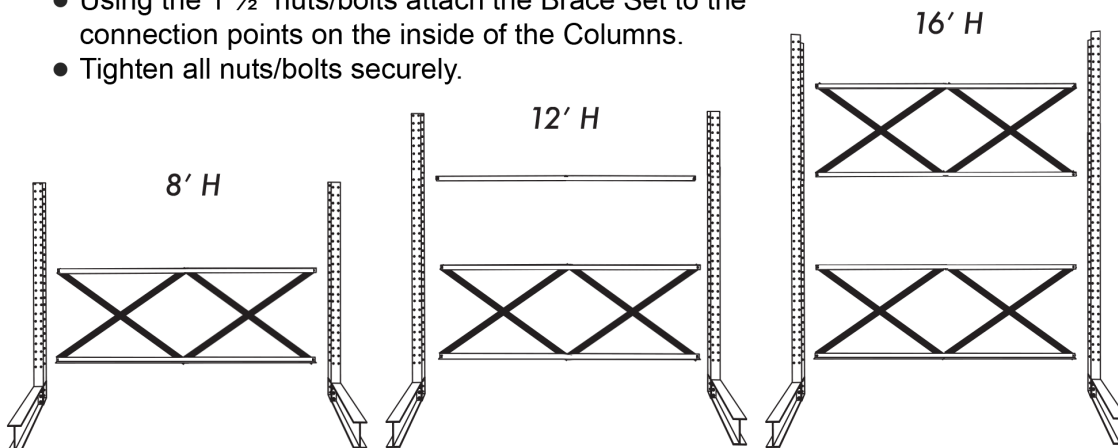

### Optional – Add-on Bay(s)

1. Attach the Base to the Column.
2. Attach the horizontal and diagonal Braces to the last open Column.
3. Stand Column up and attach to open side of the Braces.
4. Tighten all Braces.
5. Repeat for all Bays.

5

## DISCLAIMER

Action Wholesale Products recommends that this product be assembled only by qualified personnel, experienced in this assembly of storage racks, and knowledgeable of all safety regulations and practices. These instructions are intended only for use by qualified individuals using all proper safety equipment.